

ItemNo.	Part No.	Part Name	Qty.
1	C858	CO2 Regulator Replacement Gauge-Bottom Connection 0-160 PSI	1
2	C296.03	Co2 Adapter CGA-580 Nut	1
3	C5610.01	Co2 Adapter Rod	1
4	C871.01	Precesion Co2 Regulator	1
5	C446.01	Ball Valve Body	1
6	C446.02	Hex Nipple for 5/16" Vinyl ID & 3/8" Poly ID	1
7	C446.13.02	Handle Grip DEHP Free	1

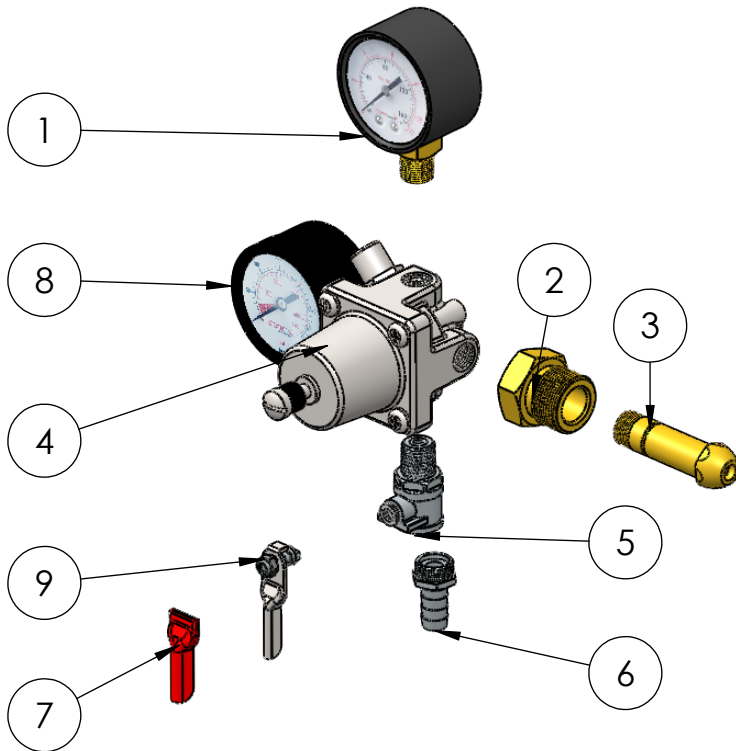

US & Canada :- +1-678 666 2001
Asia:- +91-9814203010

Krome Dispense reserves the right to make revisions to product specifications without any notice
For most updated specification sheet , go to