

Threading 5/8" x 14 BSP

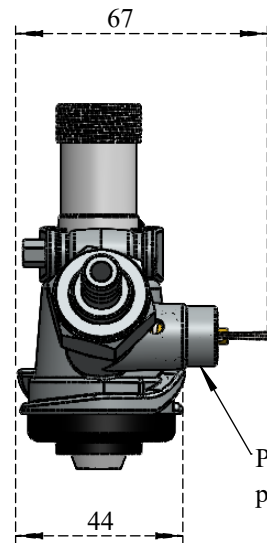

Pressure Release valve for Releasing pressure when it exceeds 60PSIG

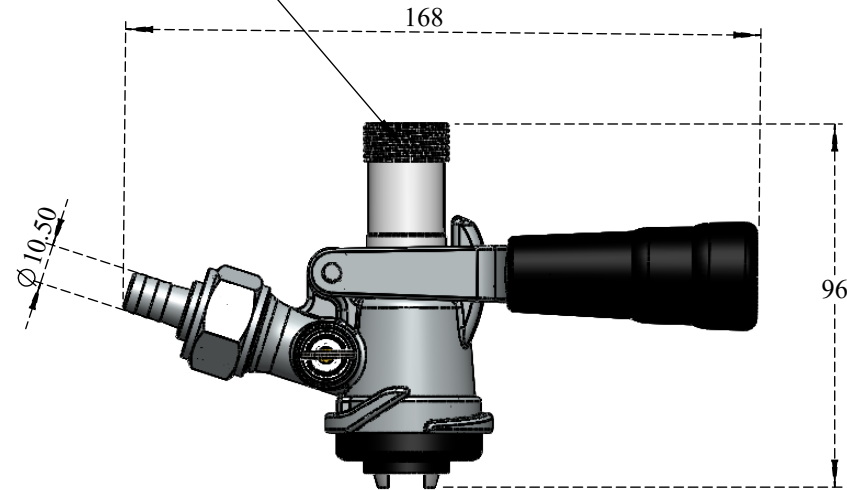

Last Revision 1

PACIFIC	UNLESS OTHERWISE SPECIFIED: DIMENSIONS ARE IN MILLIMETERS		DIMENSIONS		Tolerance Dimension																																																											
	SURFACE FINISH LIMIT: $1.6 \sqrt{R}$		ALL DIM. IN M.M.		<table border="1" style="width: 100%; border-collapse: collapse;"> <tr> <td></td> <td>0.5-3</td> <td>>3-6</td> <td>>6-30</td> <td>>30-120</td> <td>>120-400</td> <td>>400-1000</td> <td></td> <td></td> <td></td> <td></td> </tr> <tr> <td></td> <td>±0.05</td> <td>±0.05</td> <td>±0.1</td> <td>±0.15</td> <td>±0.2</td> <td>±0.3</td> <td></td> <td></td> <td></td> <td></td> </tr> <tr> <td style="text-align: center;">*</td> <td colspan="2" style="text-align: center;">- IMPORTANT</td> <td>□</td> <td>□</td> <td>±0.2</td> <td>±0.5</td> <td>±1</td> <td>±1</td> <td>±1</td> <td>±1</td> </tr> <tr> <td style="text-align: center;">**</td> <td colspan="2" style="text-align: center;">- CRITICAL</td> <td></td> <td></td> <td>≤±10</td> <td>>10-50</td> <td>>50-120</td> <td>>120-400</td> <td>>400</td> <td></td> </tr> <tr> <td style="text-align: center;">***</td> <td colspan="2" style="text-align: center;">- MOST CRITICAL</td> <td>∠</td> <td></td> <td>±1*</td> <td>±0.3*</td> <td>±0.2*</td> <td>±0.1*</td> <td>±0.5*</td> <td></td> </tr> </table>							0.5-3	>3-6	>6-30	>30-120	>120-400	>400-1000						±0.05	±0.05	±0.1	±0.15	±0.2	±0.3					*	- IMPORTANT		□	□	±0.2	±0.5	±1	±1	±1	±1	**	- CRITICAL				≤±10	>10-50	>50-120	>120-400	>400		***	- MOST CRITICAL		∠		±1*	±0.3*	±0.2*	±0.1*	±0.5*
	0.5-3	>3-6	>6-30	>30-120	>120-400	>400-1000																																																										
	±0.05	±0.05	±0.1	±0.15	±0.2	±0.3																																																										
*	- IMPORTANT		□	□	±0.2	±0.5	±1	±1	±1	±1																																																						
**	- CRITICAL				≤±10	>10-50	>50-120	>120-400	>400																																																							
***	- MOST CRITICAL		∠		±1*	±0.3*	±0.2*	±0.1*	±0.5*																																																							
The Information Contained in this drawing is the property of PACIFIC MERCHANTS and should not in any way divulged to any third party without the prior written consent of the company	DRAWN BY	:Daljeet	MATERIAL																																																													
	DATE	:27-08-2021	SURFACE AREA		309257.18 mm ²																																																											
	CHKD BY	:-	VOLUME		234567.26mm ³																																																											
	DATE	:-	REVISION		:01																																																											
	APPD. BY	:-	FINISH		:Electro Polish																																																											
DATE	:-	PART NO.		C703Line																																																												
Density	0.00 g/mm ³	TITLE D System Keg Coupler Line Drawing																																																														
Drawing Weight	616.36 g																																																															
Actual Weight(g)	560g																																																															

All values are Nominal and can Vary to Some Extent